

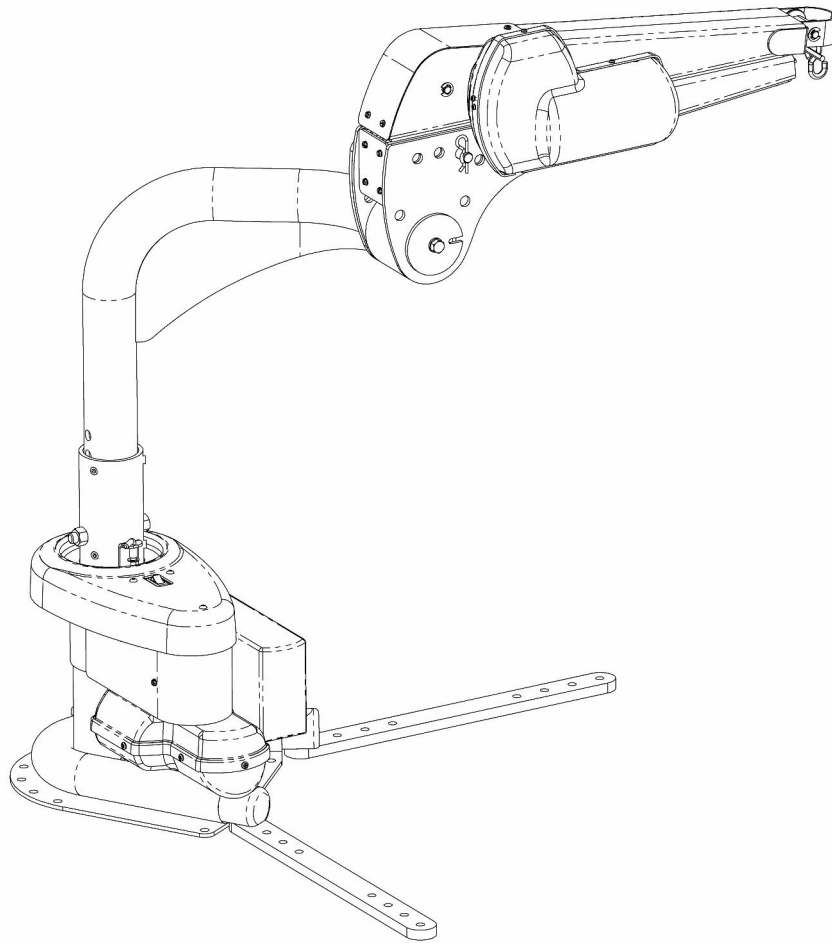

## TAILGATER PICK-UP TRUCK LIFT INSTALLATION PROCEDURES



These instructions are provided to assist you in the installation of the Tailgater Pick-up Truck Lift. If you require further assistance, our trained staff is ready to provide you with quick, efficient service. Call our toll-free number:

1-800-755-2856

Monday thru Friday, 8:00 AM – 5:00 PM (Except holidays) E.S.T

Before calling please have your customer number or order number available.

© 2002 Freedom Lift Corporation

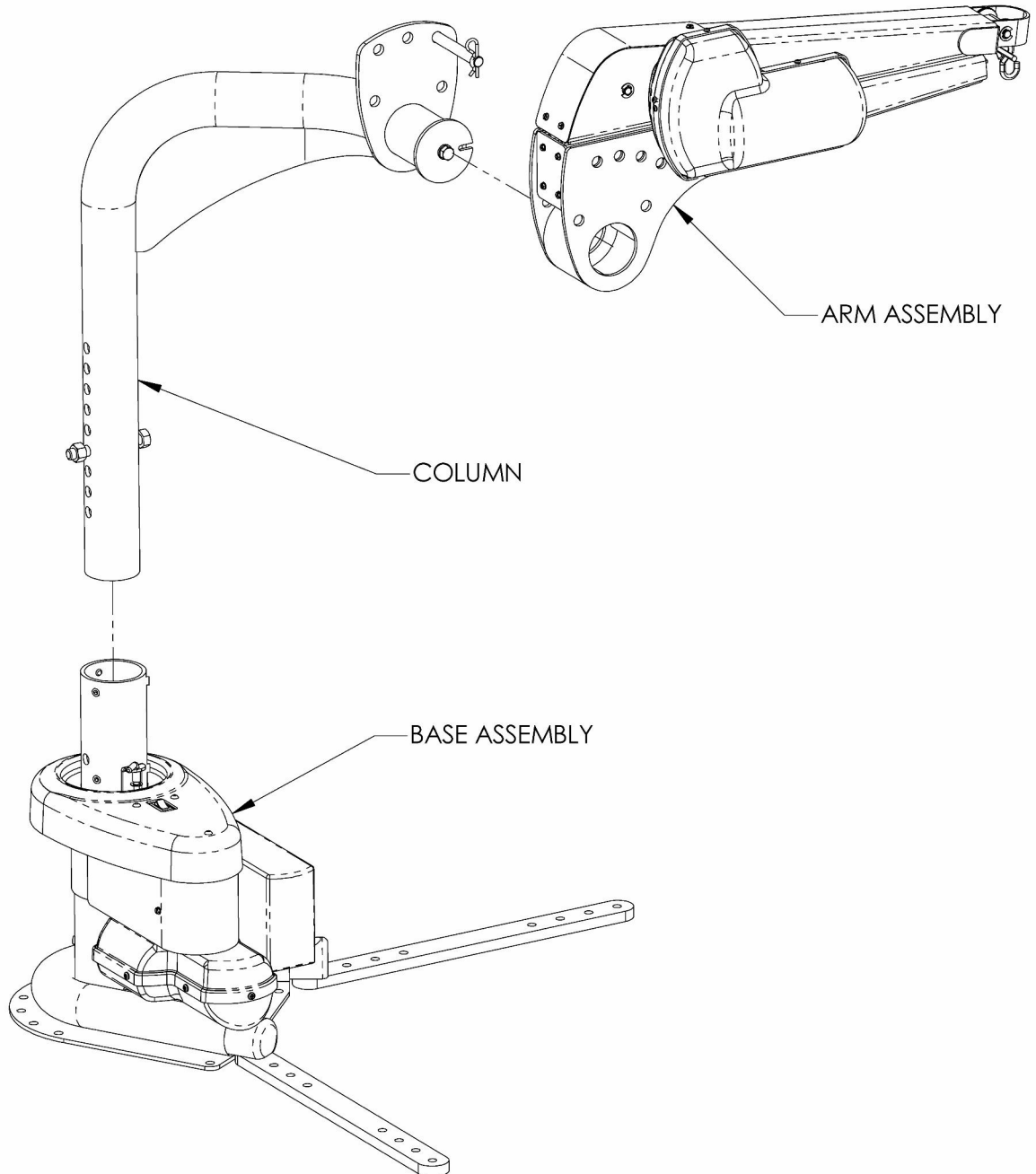

# ELECTRICAL WIRING

Wiring the lift involves running the supplied wire harness from the battery's positive and negative terminals, under the chassis of the vehicle using nylon wire ties to secure the wire, to the rear mounting location. Take care not to pinch or nick the wire.

If the harness is not long enough you may add additional 10-gauge wire minimum with butt connectors. Protect this connection from moisture with either heat shrink tubing and/or electrical tape.

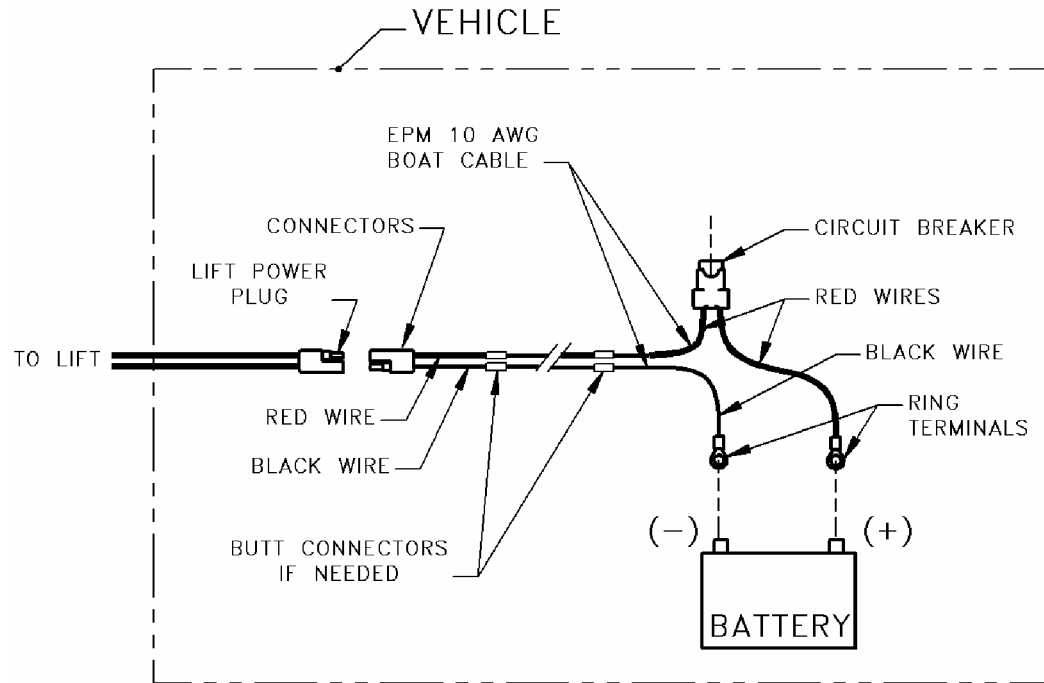

Starting at the Car Battery:

- Loosely tie the end of the wire harness with the circuit breaker near the battery. Allow enough slack for the wire to reach the terminals.
- Remove the circuit breaker from the wire harness by pulling it straight out of the holder.
- Assuming the battery is in the engine compartment, route the wire through the engine compartment. Avoid moving parts such as carburetor linkages, steering parts, fans, belts, and pulleys. Also avoid hot parts such as exhaust manifolds and pipes. Secure the wire using plastic wire ties or electrical tape.
- Pass the wire through the bottom of the vehicle's engine compartment and along the bottom of the vehicle to the cargo area. If necessary, the wire can be cut and reconnected using the supplied butt connector. Secure where possible with the wire ties provided. Avoid contacting hot parts such as the catalytic converter and exhaust system.
- Attach the ends of the wire harness (ring terminals) to the positive (+) and negative (-) battery terminals.
- When you are ready to power the lift, replace the circuit breaker located in the wire harness near the battery end.

# INSTALLATION

## STEP 1

Position the base in the vehicle at the desired location. Make sure the arm power wires are extending from the top of the rotary column as shown in Figure 1. Look for the yellow tag and remove its shipping screw from the side of the stationary column.

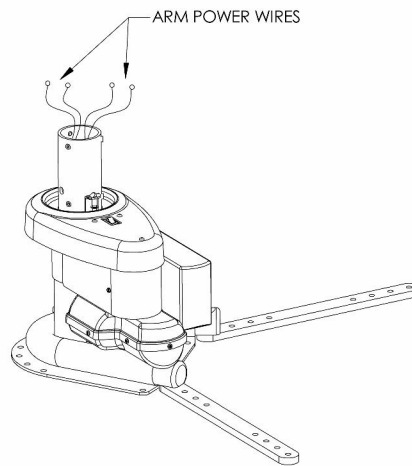

**FIGURE 1: BASE WIRING**

## STEP 2

Connect the arm power wires extending from the rotary column in the base with the wires extending from the bottom of the gooseneck column as shown in Figure 2. Match red connectors to red connectors and blue to blue. Insert the gooseneck column into the rotary column being careful not to pinch the wires. Bolt the gooseneck column to the rotary column at an appropriate height. Use the 1/2x3.75" hex bolt and lock nut as shown. Release the rotational lock and swing the gooseneck column to check the lift location within the vehicle. Adjust the base location as necessary.

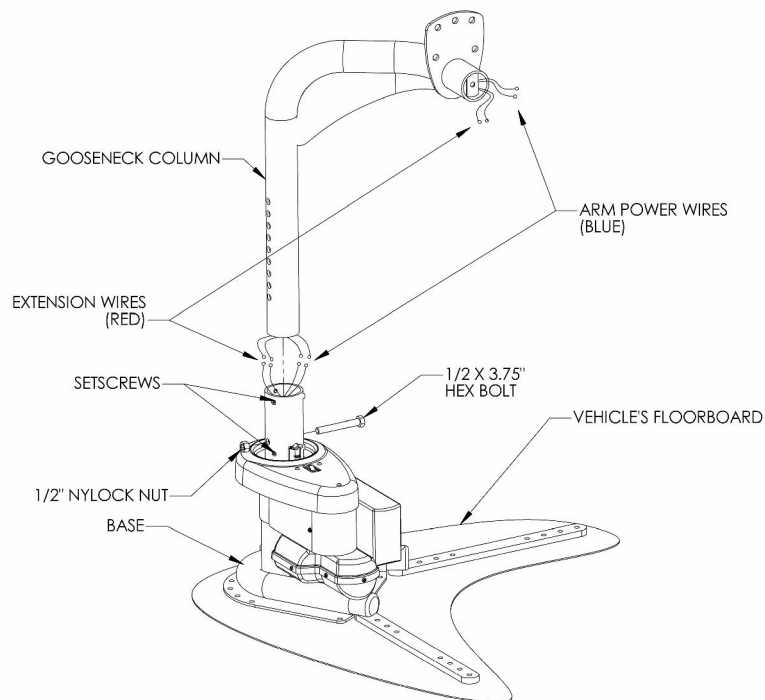

**FIGURE 2: COLUMN ASSEMBLY**

### STEP 3

**Check for vehicle components under the cargo deck before drilling any mounting holes.** Determine appropriate base mounting points. Adjust the swivel legs as necessary to obtain the most secure mounting points, avoiding interference with any components underneath the floorboard, i.e. exhaust system, fuel tank and lines, brake lines and electrical wire harness, etc. For stability, it is suggested that at least one hole be drilled and one mounting bolt be installed as shown in Figure 3 before proceeding to step 4.

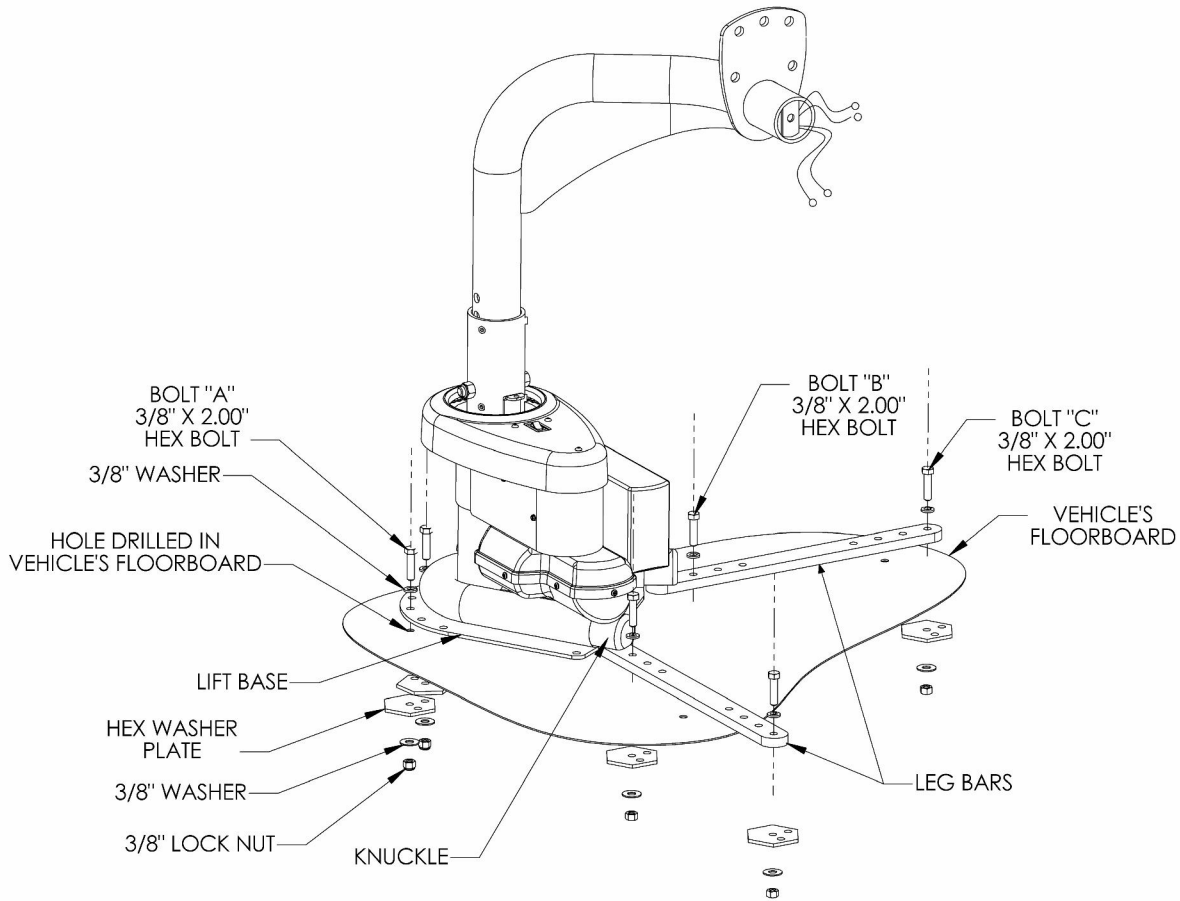
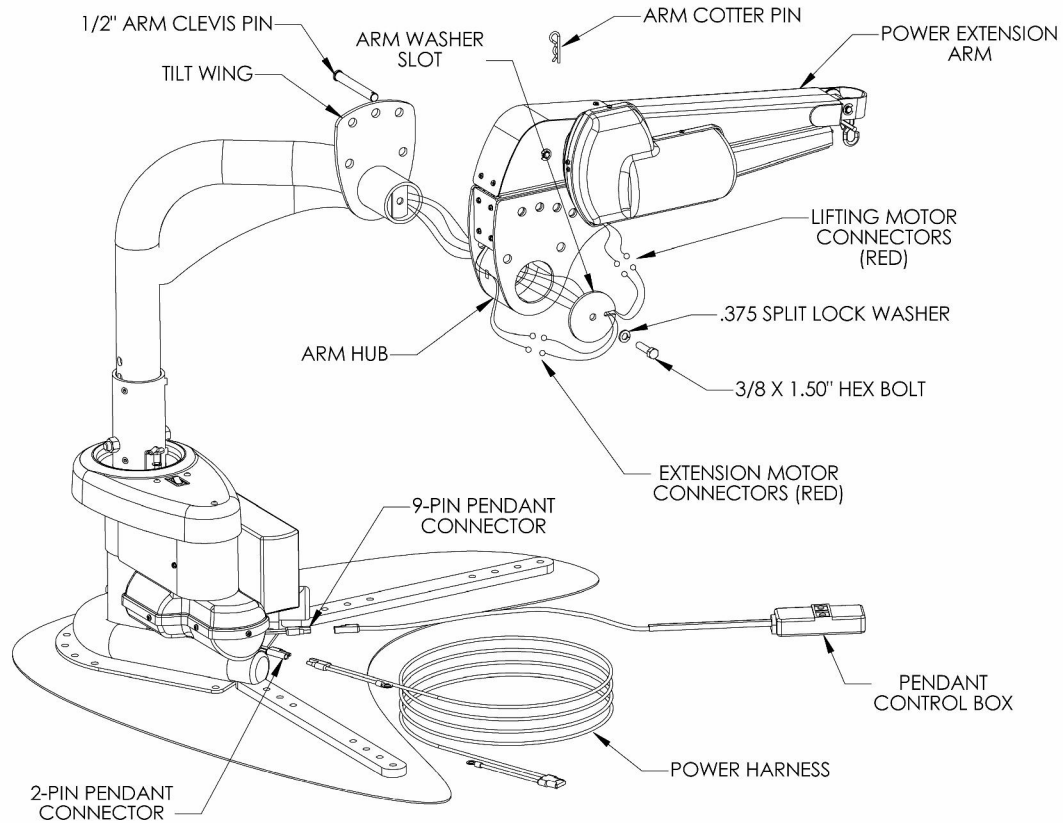

**FIGURE 3: BASE MOUNTING**

### STEP 4

Feed the arm power wires extending from the top end of the gooseneck column through the arm hub. Slide the hub onto the gooseneck column as shown in Figure 4. Insert the 1/2" arm clevis pin through appropriate angle adjustment holes in the tilt wing and the arm. Secure the clevis pin with the cotter pin.

Attach the arm washer to the end of the gooseneck column as shown using the 5/16x1.50" hex bolt and split lock washer. Take care to feed the arm power wires through the slot in the arm washer. Connect the arm power wires to the arm motors making sure to match same-colored connectors. Connect the lift's power plug to the vehicle's electrical system using the 2-pin connector on the wire harness. Connect the pendant control box to the matching 9-pin plug at the base of the lift.



**FIGURE 4: ARM ASSEMBLY**

**STEP 5**

Finish securely attaching the base mounting hardware as shown in Figure 3.

**STEP 6**

Readjust the column height, arm angle as needed to lift and load the scooter into the vehicle. Set the swing stops by turning the bolts and locking jam nuts under the chain plastic base cover until the micro switch is contacted. Figure 5 shows the stop position with the arm swung into the vehicle. The stops should be adjusted to automatically prevent the lift from hitting the vehicle.

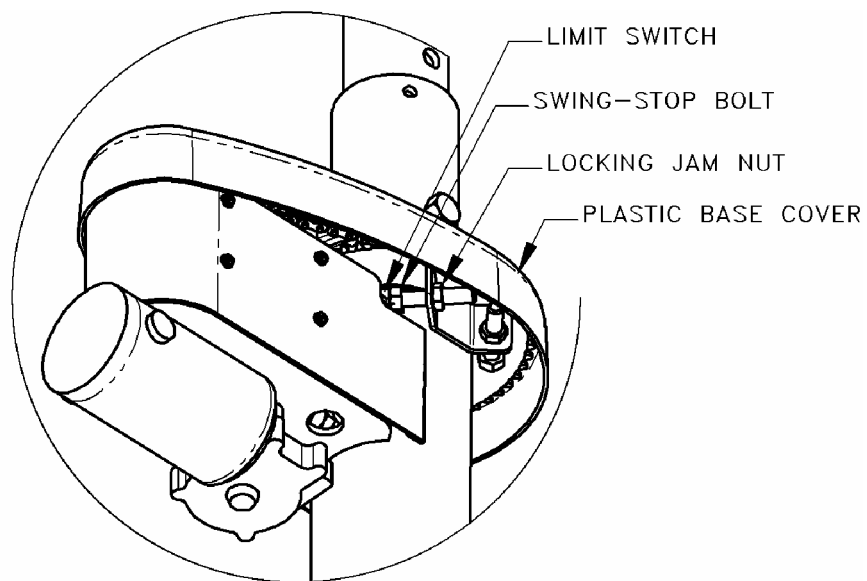

**FIGURE 5: SWING STOP ADJUSTMENT**